

AIRPORT DIAGRAM

AL-407 (FAA)

STOCKTON METROPOLITAN (SCK)
STOCKTON, CALIFORNIA

SW-2, 03 JUL 2008 to 31 JUL 2008

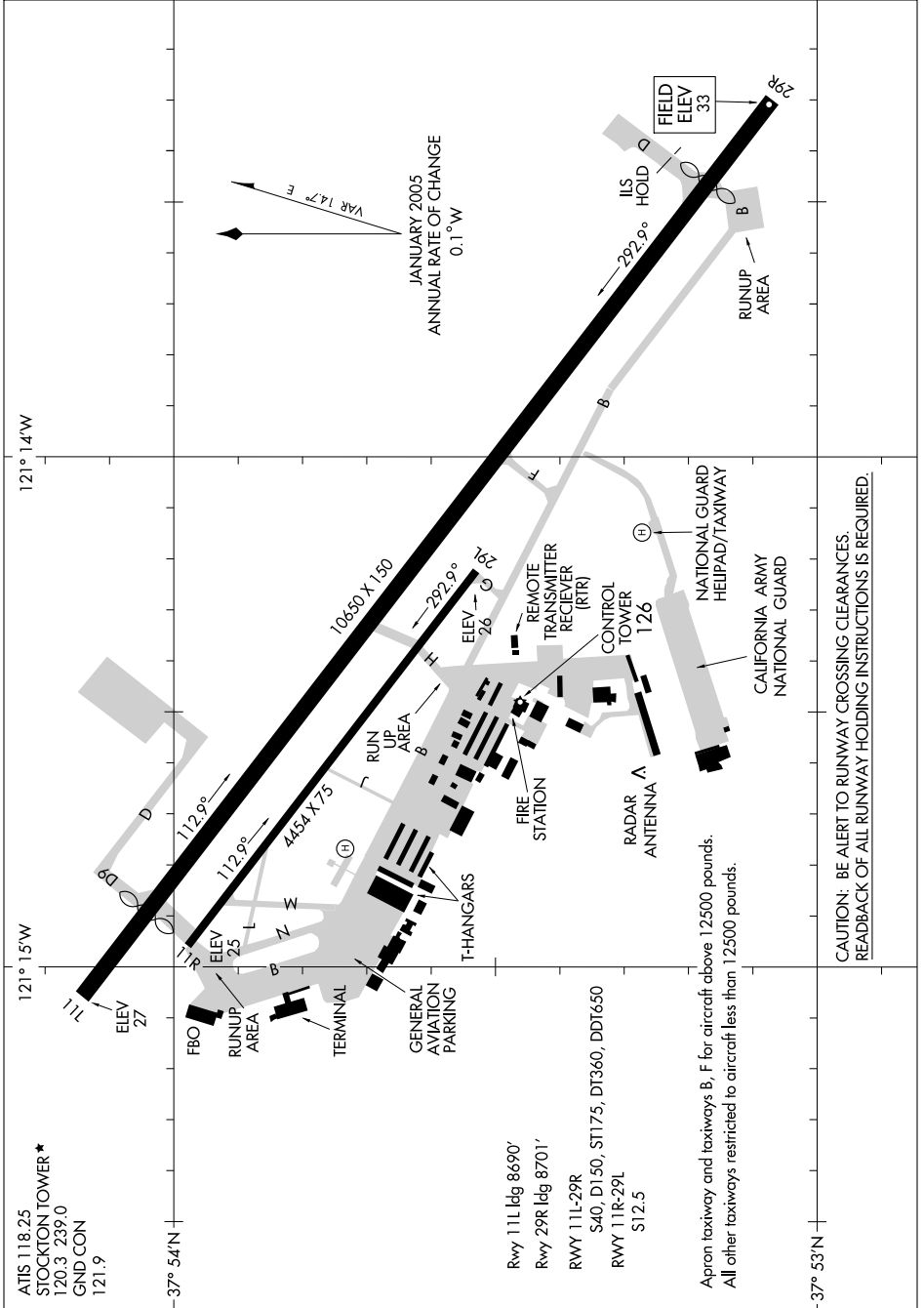

ATIS 118.25
 STOCKTON TOWER ★
 120.3 239.0
 GND CON
 121.9

Rwy 11L ldg 8690'
 Rwy 29R ldg 8701'
 Rwy 11L-29R
 S40, D150, ST175, DT360, DDT650
 Rwy 11R-29L
 S12.5

Apron taxiway and taxiways B, F for aircraft above 12500 pounds.
 All other taxiways restricted to aircraft less than 12500 pounds.

CAUTION: BE ALERT TO RUNWAY CROSSING CLEARANCES.
 READBACK OF ALL RUNWAY HOLDING INSTRUCTIONS IS REQUIRED.

SW-2, 03 JUL 2008 to 31 JUL 2008

AIRPORT DIAGRAM

STOCKTON, CALIFORNIA
STOCKTON METROPOLITAN (SCK)